

INSTRUCTIONS FOR USE:

Thank you for purchasing the Bigboi Buddi. Before you start enjoying the features and benefits of touchless drying please take a minute to read the below and familiarizes yourself with the dryer.

IN THE BOX

- Bigboi Blower Buddi
- 1 replacement filter
- 2 hose nozzles

Open the dryer box, take out the dryer, and check its appearance, if there is no damage; go on with following steps:

1. Place or fix the dryer, connecting the desired nozzle with an screwing motion, fastening the nozzle to the unit.
2. Plug in the dryer (please make sure the power supply voltage in your country matches the machine);
3. Switch on the dryer and adjust it to your desired wind speed. Then the dryer can begin the drying process.

IMPORTANT NOTICE

1. This machine use AC power source, power must have good grounding before used.
2. To maintain a smooth flow of air, please keep a safe distance from the surface. This will allow the warm filtered air to travel smoothly over a larger surface making the drying more efficient and preventing Taking in water which may damage the machine.
3. Clean the filter regularly to ensure a smooth air flow.
4. Do not let minors close or play with the machine!

MAINTENANCE INSTRUCTION

1. The shell of the machine can be cleaned with a soft cloth and neutral detergent solution (to avoid spoiling the paint work) then use a dry cloth to clean it;
2. Use water or strong fan to clean the filters regularly. Note that filters cannot be fixed on the machine until it is totally dry, in case the water may damage the machine. The machine has a standby filter packaged with it.
3. When the machine runs out of carbon brush, please contact a professional to check and update the required parts.

For further information on any Bigboi products, please contact info@bigboi.com.au

BIGBOI BLOWR BUDDI INSTRUCTION MANUAL

BLOW^R BUDDI



TOUCHLESS

CAR, MOTORCYCLE & MARINE

DRYER

STRUCTURE REPRESENTATION

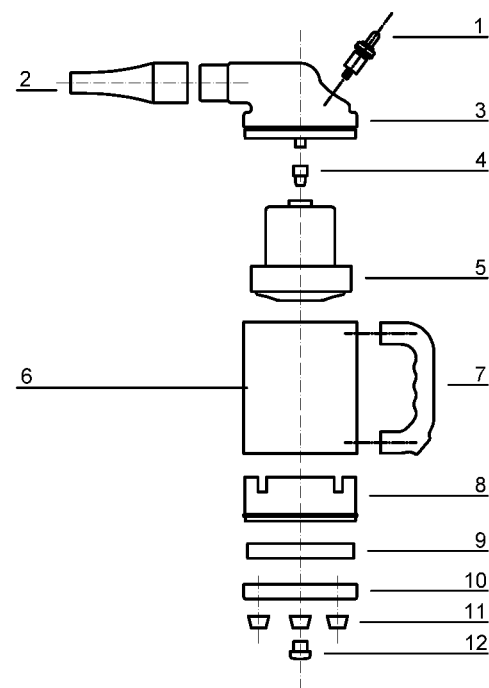

NO.	Name	Amount
1	Power switch	1
2	Nozzle	1
3	Front cover	1
4	Rubber mat	2
5	Electric fan	1
6	Cover component	1
7	Handle	1
8	Back cover	1
9	Filter	1
10	Outer elimination cover	1
11	Mats	3
12	Nut	1

PRODUCT FEATURES

See the label of the machine.

FUNCTIONS & FEATURES

Soft Start

Thanks to the protection from current buffers, when the dryer starts, the dryers will not discharge any impulse current, exerting no adverse influence upon the neighboring working electrical equipment.

Low Noise and Powerful Airflow

The specially-designed noise reduction system will deliver 10%-greater airflow than any other single-motor dryers, with over 1.4HP (1000watts) this model can dry your car, motorcycles, boat or ski faster in a less noise environment which will benefit the operator.

Full Function

This model is especially designed with high speed setting, which can work at full speed, as well as minimum airflow and high-heat settings, allowing precision drying and accurate wind speed when needed.

BBT (Bigboi Temperature Technology)

2 Stage adjustable warm filtered air fixed at 25c higher than the surrounding environment. All this available at a touch of your fingertips.

Adjustable wind control

The toggole switch above the handle is the wind control switch. This will allow the user to adjust the wind speed from 70kmh to 220kmh.

Accessories

Visit **your supporting countries distributor website** to see how you can make your blower even more awesome with accessories.