

BIGBOI SUCKRPRO INSTRUCTION MANUAL

SUCK**R**PRO



WET & DRY **VACUUM CLEANER**

Please read the operating instructions carefully before use.

WARRANTY INFORMATION

	BIGBOI OFFERS A 2-YEAR LIMITED WARRANTY INTENDED FOR NON- COMMERCIAL USE
--	---

PROOF OF PURCHASE

Please keep your dated proof of purchase for warranty and servicing purposes.

REPLACEMENT PARTS

Replacement parts for this product are available at www.ibigboi.com.
Please use the part numbers listed in this manual for all part orders where applicable.

LIMITED TOOL WARRANTY

BIGBOI makes every effort to ensure that this product meets high quality and durability standards. BIGBOI warrants customers a 2-year limited warranty as of the date the product was purchased at retail and that each product is free from defects in materials. Warranty does not apply to defects due directly or indirectly to misuse, abuse, normal wear and tear, negligence or accidents, repairs done by an unauthorized service Centre, alterations, or lack of maintenance.

To take advantage of this limited warranty, return the product at your expense together with your dated proof of purchase to BIGBOI or any authorized resellers in your region.. Contact our customer service for corresponding help. BIGBOI will either repair or replace the product if any part or parts covered under this warranty which examination proves to be defective in workmanship or material during the warranty period.

NOTE TO USER

This instruction manual is meant to serve as a guide only.
Specifications and references are subject to change without prior notice.

BIGBOI INTERNATIONAL PTY LTD

UNIT 33/172 Milperra road Revesby NSW 2122 Sydney Australia.

GENERAL & SPECIFIC SAFETY RULES

Safety is a combination of common sense, staying alert and knowing how your SUCKR PRO works. Read and understand the following safety rules before operating. Learn its application and limitations as well as its specific potential hazards.

1.REMOVE ADJUSTING KEYS AND WRENCHES.

Form a habit of checking to see that keys and adjusting wrenches are removed from tool before turning it on.

2.KEEP WORK AREA CLEAN.

Cluttered areas and benches invite accidents. Ensure the floor is clean, clutter free and not slippery.

3.AVOID DANGEROUS ENVIRONMENTS.

Do not use the unit in damp or wet locations or expose it to rain. Keep work area well-lit and provide adequate surrounding work space. Do not handle the electrical plug or unit with wet hands. Never vacuum anything that is on fire, burning or smoking such as matches, cigarettes or hot ashes. Never vacuum flammable or combustible liquids such as gasoline or electrical devices which could produce sparks and cause a fire or explosion! Never vacuum toxic or hazardous materials.

When wet vacuuming, operate the unit only when the container is level, otherwise there is a risk of electric shock

4.KEEP AWAY FROM CHILDREN.

All children should be kept a safe distance from work area.

5.USE CORRECT SPEED.

The unit best performs when operated at the correct speed.

6.USE FOR THE RIGHT PURPOSE

Do not force the unit or the attachments to do a job for which it was not designed.

7.WEAR APPROPRIATE CLOTHING.

Where appropriate, wear a dust mask, hearing protectors, gloves and workshop apron capable of stopping small abrasive or workpiece fragments

Do not wear loose clothing, gloves, neckties or jewellery to avoid risk of getting caught in moving parts.

Non slip footwear is recommended. Wear protective

hair covering to contain long hair. Roll up long sleeves above the elbows.

8.ALWAYS WEAR SAFETY GLASSES.

Always wear safety glasses. Everyday eye-glasses only have impact resistant lenses, they are NOT safety glasses..

The safety glasses must be capable of protecting against flying particles generated by the various operations.

SPECIFIC SAFETY RULES :

1.The appliance is not to be used by persons (including children) with reduced physical, sensory or mental capabilities, or lack of experience and knowledge, unless they have been given supervision or instruction.

2.Children being supervised not to play with the appliance.3.That the plug must be removed from the socket-outlet before cleaning or maintaining the appliance.

4.If the supply cord is damaged, it must be replaced by the manufacturer, its service agent or similarly qualified persons in order to avoid a hazard.

9.DON'T OVERREACH.

Keep proper footing and balance at all times.

10.AVOID ACCIDENTAL STARTING.

Make sure the switch is in the "OFF" position before plugging in.

11.USE RECOMMENDED ACCESSORIES.

Consult the manual for recommended accessories. Follow the instructions that accompany the accessories. The use of improper accessories may cause hazards.

12.NEVER STAND ON THE UNIT.

Serious injury could occur if the unit tips over. Do not place materials on top of the unit to stand on.

13.CHECK DAMAGED PARTS.

Before further use of the SUCKR PRO, a guard or other parts that are damaged, should be carefully checked to ensure that they will operate properly and perform their intended function. Check for alignment of moving parts, breakage of parts, mounting, and any other conditions that may affect its operation. A guard or other parts that are damaged should be properly repaired or replaced.

14.NEVER LEAVE MACHINE RUNNING UNATTENDED.

Turn power "OFF". Don't leave any tool running until it comes to a complete stop.

15. STORING THE SUCKR PRO

This unit must be stored indoors. -5°C to +40°C

16. Never use this vacuum without dust bag and/or filters installed. The replacement HEPA and High Efficiency filters and accessories are available and are listed in the parts list.

17. Never use this vacuum with any opening blocked, keep opening free of dust, hair, lint or anything that will restrict air flow.

18. Only use undamaged power cords and regularly check condition of extension cords.

1.CONDITIONAL MARKS

General warning sign



(Risk to people, explained
by additional sign or text)



See the instructions on safety and
operation techniques/brochure



Wear hearing protection



Wear eye protection



Wear a mask



Risk of electric shock !



Alternating current

IP

Degree of protection
against dust and water



Special disposal to prevent possible
damage to the environment, it is
necessary to separate this object
from ordinary waste and dispose of
it in the safest way)

2.GETTING TO KNOW YOUR SUCKR PRO

- 1.Sofa brush
- 2.Vacuum cleaner tank
- 3.Lock catch
- 4.Air outlet plate
- 5.Extension plastic tube
- 6.Hose connector
- 7.Cover
- 8.Handle
- 9.Operation mode switch
- 10.Hose
- 11.Set of transport wheels
- 12.Remote
- 13.Crevice tool
- 14.Dust Bag
- 15.HEPA filter
- 16.Small round brush
- 17.Rotating floor brush
- 18.Flat flexible crevice tool
19. Tiny tube tool
- 20.8pcs micro kits
- 21.Pet tool

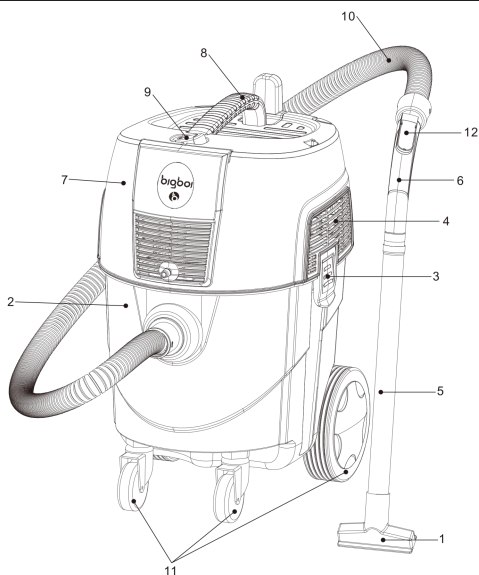

Pic.1



13



14



15



16



17



18



19



20



21

EXTRACTOR KITS (SOLD SEPARATELY)



Pic 2

1. 4.5L water tank 2. Spray crevice tool 3. 6inch Spray brush
4. 5M spray hose 5. 3pcs drill brush 6. Accessory bag
7. 3inch Spray brush



BIGBOI is constantly working on improving its products and reserves the right to make changes to the appearance, design, equipment, and content of the original instructions for the safety and operation of the SUCKR PRO without notifying consumers. All possible changes will be aimed exclusively at the improvement and modernization of the SUCKR PRO.

3.TECHNICAL DATE

Parameter	SUCKR PRO
Rated voltage	220-240 V
Frequency	50/60HZ
Rated Power	1600W
Container volume	30L
Wet volume(max)	14L
Water tank(extraction)	4.5L
Vacuum Pressure (inches of water)	84.3inchH2O
Air suction capacity at Air Inlet	40L/S
Suction (max)	22 KPA
Pump Power	≤21W
Degree of protection against dust and water	IP24
Hose diameter	32mm
The length of the power cord	8M
The length of the hose	5M
Tank material	PP
Noise	≤82db



The parameters are indicated for a nominal voltage of 220V 240V with a frequency of 50/60 Hz. At other values of voltage or frequency, other parameters are possible.

4. PREPARATION FOR WORK



Before preparing to use, during maintenance and after use of the SUCKR PRO, Unplug the plug from the socket.

Unpack and remove the SUCKR PRO and accessories from the packaging. Inspect for external damage. If you have stored or transported the unit at a temperature lower than for the one in which it is planned to be used, it is necessary to make sure that there is no condensation in the SUCKR PRO. If condensation forms on the components and parts of the SUCKR PRO, its further preparation for work or operation is prohibited until the condensation dries completely.

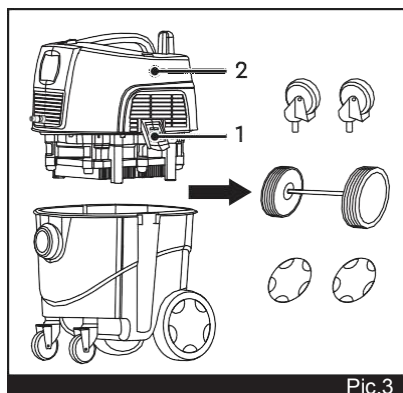

Pic.3

Assembling the SUCKR PRO

Release the lock (1) of the SUCKR PRO to remove the cover (2), pull out the transport wheels and accessories (Pic.3)

Install the four transport wheels (1) (Pic.4)

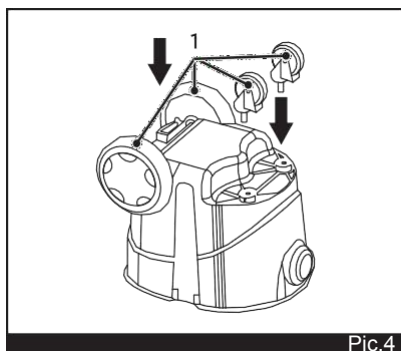

Pic.4

Connect the extension tube (1) into one rod (Pic.6).
Install the hose (3) into the connector of the SUCKR PRO (4).
Connect the hose connector (2) to the rod. Install the sofa brush or narrow nozzle to your cleaning tool (Pic.5).

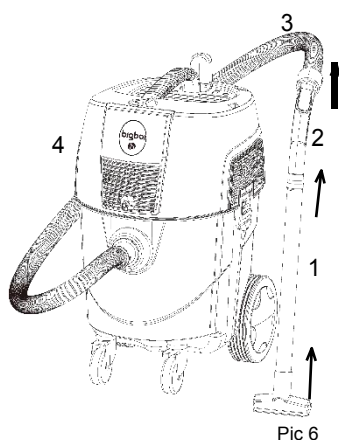

Pic.6

For hard-to-reach areas, use the crevice tool (3)(Pic.5)

Do not use the SUCKR PRO to suck up large pieces of garbage or household waste. This can lead to clogging of the rod, flexible hose, or clogging of the nozzle.

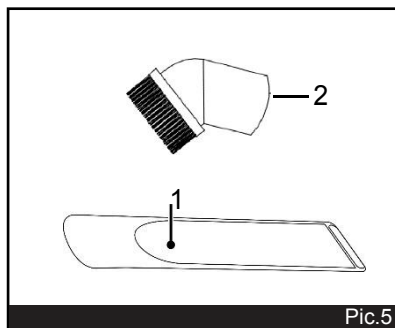

Pic.5

Installing the filter

Pull out the eccentric latches (2) from the SUCKR PRO cover body. Install the cassette filter (1) and fix it with eccentric clamps (Pic.7). Depending on the operating conditions, install a paper filter bag in the SUCKR PRO.

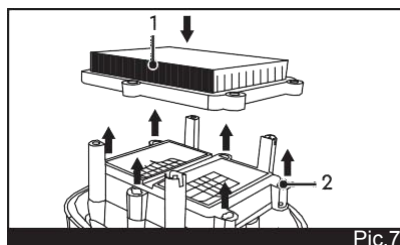

Pic.7

Installation of a replaceable filter dust bag (Pic.8)

- Install the replaceable filter bag (1) on the seat (3). The rubber seal (2) must fully enter the corresponding groove.
- Pull the filter bag in the opposite direction to the installation to check the fit.

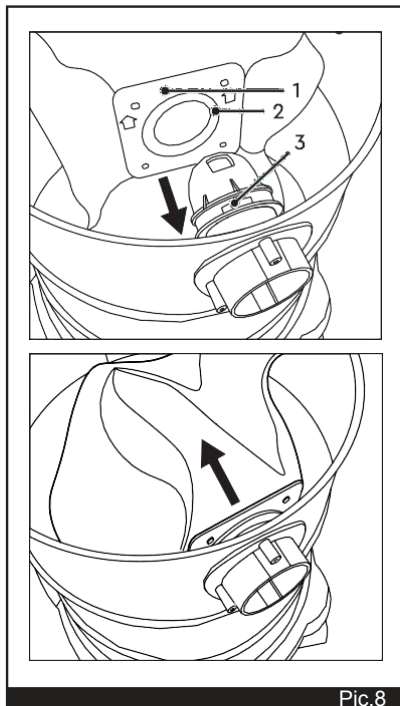

Pic.8



Pic.11

4. Remote Control --Code matching : when the remote not works or use another new remote, code matching is required
 Turn the switch to position 'I' (Pic 9) Press the setting button(S) twice (Pic 11) , press on/off(A) on the remote (Pic 10)
) The SUCKR PRO stops working when matching. Then after 10 seconds, the remote works (Note : SUCKR PRO already matched its own remote, can work directly when receive)

5.WORKING WITH THE SUCKR PRO



The SUCKR PRO is recommended to work at an ambient temperature of +5°C to +40°C.

A.VACUUM FUNCTION (WET&DRY)

1. Insert the plug into the outlet. Turn the switch to position "I" to turn on the SUCKRPRO automatically . And the remote also controls the SUCKRPRO on/off. (Pic.9)

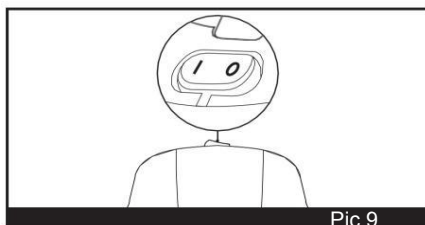

Pic.9

2. Press the on/off button (A) on the remote, choose between speed 3 settings low, medium & high (pic 10)

△ High Power+

▽ Low Power-

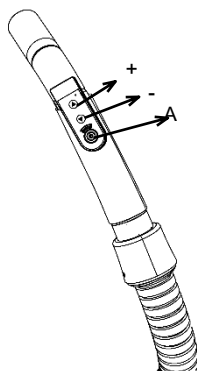

Pic10

3. To stop the machine, press the on/off switch 'O' position.

Note: The dust bag is suitable only for dry vacuum-cleaning ONLY!

B. EXTRACTION FUNCTION (KIT SOLD SEPARATELY)

1. Fitting the water pipe, pic12

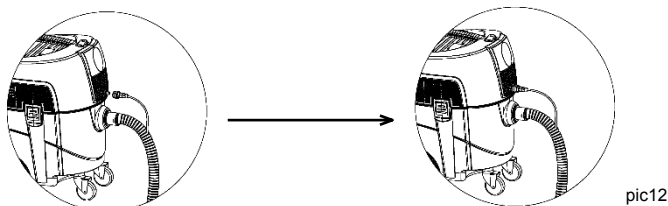

2. Remove the current vacuum hose & Connect the extractor hose, install the spray brush or spray crevice tool
3. Install the water tank pic13

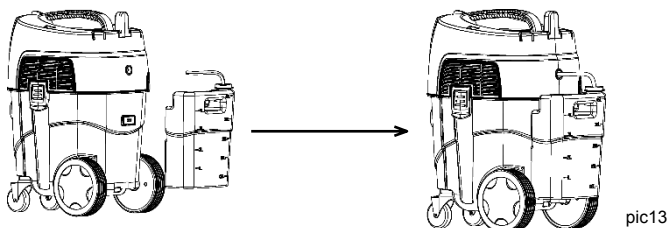

4. Insert the plug into the outlet. Press the on/off switch (pic 1) on the unit.
5. When the first use XTRACTR KIT, code matching is required, steps as follows,
Turn the switch to position 'I' (Pic 9) , the SUCKR PRO starts working
Press the setting button(S) twice (Pic 11) , press V or S on the remote (Pic 14)
The SUCKR PRO stops when matching . Then after 10 seconds, the remote works. (Note: The remote can not work when matching) Restart the SUCKRPRO(press the button'0' , then 'I' again) (Pic 9) , it'll work automatically.
6. Press the " V " button of the remote to control the wet or dry vacuum cleaner function;
7. Press the " S " button to start the water spray function. The second press, the spray pump motor will stop(pic14)

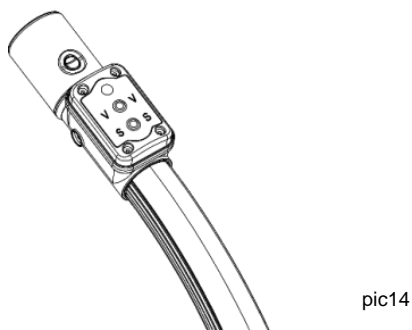

8. To turn off the unit, Select " O " on the main power switch located on the unit, pic9

6.SERVICE



Wear a mask

Regularly (preferably after each use) wipe the body of the unit and accessories with a soft cloth or blow with compressed air.

After dry cleaning:

- Open the lock of the unit.
- Clean the unit (**Pic.15**).



Note: Large objects can get caught in the brush, which can cause it to overheat. Be sure to pick up large objects that may cause blockages before cleaning.



Never use solvents or other aggressive chemicals to clean non-metallic parts of the SUCKR PRO.

These chemicals can degrade the properties of the materials used in these parts. Do not allow any liquid to get inside the SUCKR PRO.

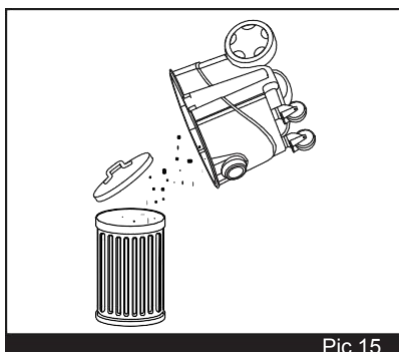

Pic.15

-When using a paper bag, remove it, dispose of it and install a new bag.

After wet cleaning:

-Remove the upper part of the vacuum cleaner, pour out the collected liquid, shake or blow the inside of the tank, wash the filter and collect the vacuum cleaner.

-Do not bend the cassette filter or clean with coarse brushes.

Filter maintenance

Remove the cassette filter from the top cover of the vacuum cleaner, rinse with water and dry (Pic.16).

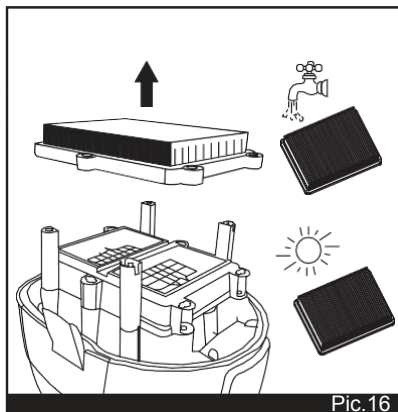

It is strictly forbidden to operate the unit without an installed filter.



Filters are installed on the base located in the lower part of the electric motor section. If the filter breaks, you should immediately turn off the unit and replace the filter with a new one. Regular cleaning contributes to the long-term maintenance of maximum suction power.



To prevent mold formation, remove the filter after use and dry it well, especially before dry vacuuming usage. The warranty does not cover consumables that wear out. Replaceable components such as HEPA filters, textile and paper bags, etc., must be replaced as they wear out.

7.STORAGE AND TRANSPORTATION

It is recommended to store the SUCKR PRO in a dry place inaccessible to children, at a temperature from -5°C to $+40^{\circ}\text{C}$, with a relative humidity of no more than 80%. If you have stored or transported the unit at a temperature lower than that at which you plan to use it, you must ensure that there is no condensation on the unit. If condensation forms on the components and parts of the unit, its further preparation for work or operation is prohibited until the condensation dries completely.

For storage and transportation, use the original or other packaging to avoid damage to the unit and its accessories during transportation.

The unit can be transported by all types of transport, in accordance with the general rules of transportation. During loading and unloading operations and transportation, the unit should not be exposed to shocks and atmospheric precipitation.

Placement and fastening of the unit in vehicles must ensure a stable position and the absence of the possibility of its movement during transportation.

8.DISPOSAL



Do not throw away the SUCKR PRO together with household waste. Units that have been removed from operation are subject to separate storage and disposal in accordance with environmental protection legislation.

9.POSSIBLE FAULTS AND METHODS OF THEIR ELIMINATION

Malfunction	Possible reason	Handling method
Engine housing overheating	Poor cooling	Clean the ventilation holes. Make sure that the ventilation holes are not closed during operation.
	Contamination of the filter element	Clean the filter element.
	Mismatch of network parameters	Make sure that the electrical network has a voltage of 220-2400V and a current frequency of 50 Hz..In case of discrepancy, use a voltage stabilizer.
Weakening of suction power	The bag is full	Replace the bag. Make sure that the new bag is correctly installed and straightened.
	Clogging in the hose/nozzle	Turn off the vacuum cleaner. . Mechanically clean the hose/nozzle. Do not suck up large pieces of garbage and or household waste.
	Contamination of the filter	Mechanically clean the filter by shaking it or blowing it with compressed air.

10. PARTS DIAGRAM MODEL SUCKR PRO

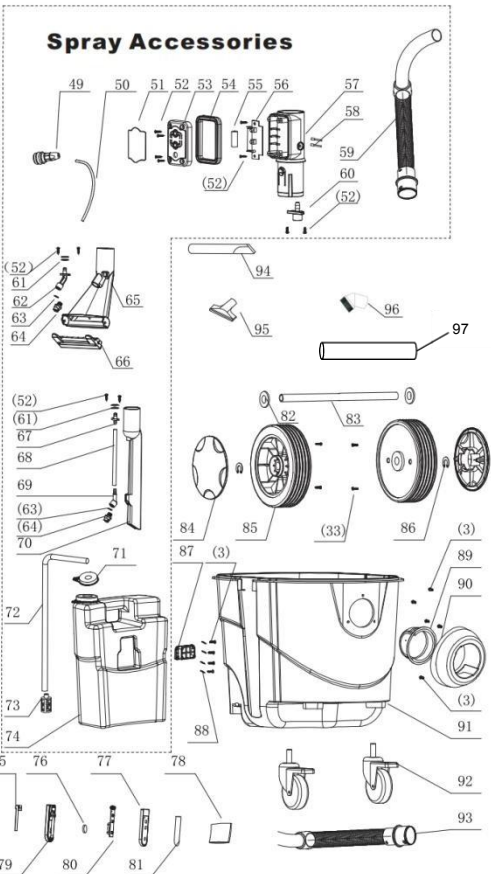

11. PARTS LIST

MODEL SUCKR PRO

NO.	Item	QTY	NO.	Item	QTY	NO.	Item	QTY	NO.	Item	QTY
1	Handle Cover	1	31	Sealing End	2	61	Sealing Ring	4	91	Tank	1
2	Handle	1	32	Pressing Block	2	62	Hose Connector	1	92	Metal Front Wheels	2
3	ST4X16 Screw	44	33	ST3X10 Crossed Screw	6	63	Sprayer Sealing Ring	2	93	Hose	1
4	Top Cover	1	34	Blanking Cover	2	64	Sprayer	2	94	Crevice Tool	1
5	ON/OFF Switch(2P)	1	35	Blanking Cover Sealing Ring	2	65	Spray Brush	1	95	Sofa Brush	1
6	Wire Ties	2	36	Blanking Cover Base	2	66	Rotated Strip	1	96	Round Brush	1
7	Air Outlet(R)	1	37	Motor Upper Sealing Ring	1	67	Pin	1	97	Plastic tube	1
8	Spray Penel	1	38	Motor	1	68	Pipe	1	98	Setting button	1
9	Pipe Pin Connector	1	39	Motor Down Sealing Ring	1	69	Angled Sprayer	1	99		
10	Joint Base	1	40	Conducting Probe	2	70	Big Spray Crevice Tool	1	100		
11	Water Pipe Junctor	1	41	Bottom Base Sealing Strip	1	71	Water Tank Cap	1	101		
12	Pipe Rear Top Cover	1	42	HEPA Sealing Strip	1	72	Pipe inside the Tank	1	102		
13	Air Outlet(L)	1	43	Buckle	2	73	Filter Net	1			
14	Water Pump Holder	1	44	Motor Bottom Base	1	74	Water Tank	1			
15	Water Pump	1	45	HEPA Base	1	75	Circuit Board Holder	1			
16	ST4X18 Screw	4	46	HEPA	1	76	Button Cell	1			
17	Motor Upper Cover	1	47	HEPA Pressing Block	1	77	Vacuum Remote Upper Cover	1			
18	Pipe Front Top Cover	1	48	Locked Fastener	6	78	Foam	1			
19	ST4X12 Screw	2	49	Water Pipe Socket Connector	1	79	Vacuum Remote Down Cover	1			
20	ST3X10 Screw	4	50	Pipe inside the Hose	1	80	Remote Circuit Board for Vacuum	1			
21	Circuit Board	1	51	Label on the Remote	1	81	Label for Remote	1			
22	Pressing Line Board	1	52	ST3X10 Nibbed Screw	12	82	Rear Wheel Gaskets	2			
23	Power Cord Cover	1	53	Remote Cover	1	83	Wheel Rod	1			
24	Power Cable	1	54	Remote Cover Sealing Ring	1	84	Rear Wheel Cover Board	2			
25	Motor Middle Cover	1	55	Battery	1	85	Rear Wheels	2			
26	280mm Connected Line	2	56	Remote Circuit Board for Spray	1	86	Rear Wheel Clamp Spring	2			
27	380mm Connected Line	2	57	Circuit Board Cover	1	87	Water Tank Hanger	1			
28	Pressure Relief Valve	1	58	Rivet	3	88	Screw Sealing Ends	4			
29	Pressure Relief Valve Spring	1	59	Hose	1	89	Air inlet hose Base Gasket	1			
30	Pressure Relief Valve Sealing Ring	1	60	Socket	1	90	Air Inlet Hose Base	1			