



# INSTRUCTION MANUAL

WASH<sup>R</sup>FLO



Read and follow all safety precautions in instruction manual.  
IMPROPER use can cause serious or fatal injury.  
Keep this manual handy.





## GENERAL SAFETY RULES

### **WARNING**

Read and understand all instructions.

Failure to follow all instructions listed below may result in electric shock, fire and/or serious personal injury.

## GENERAL OPERATIONAL PRECAUTIONS

### 1. WORK AREA

- a. **Keep work area clean and well lit.** Cluttered benches and dark areas invite accidents.
- b. **Do not operate washer in explosive atmospheres, such as in presence of flammable liquids, gases, or dust.**
- c. **Keep bystanders, children, and visitors away while operating a washer.** Distractions can cause you to lose control.

### 2. ELECTRICAL SAFETY

- a. **The voltage indicated on the rating plate must correspond to the voltage of the power source.**
- b. **If the supply cord is damaged, it must be replaced by the manufacturer, its service agent or similarly qualified persons in order to avoid a hazard.**
- c. **Never touch the mains plug with wet hands.**
- d. **Do not pull plug while operating the device.**
- e. **Do not run over, crush or pull the power supply cable or extension lead, otherwise it may be damaged.** Protect the cable from heat, oil and sharp edges.
- f. **Do not use the appliance, if the power supply cable or important parts, e. g. high-pressure hose, trigger gun or safety devices are damaged.**
- g. **If an extension cord is used, the plug and socket must be of watertight construction.** The extension cord must have a cross section in accordance with the operating instructions and be protected against splashed water. The connection must not be in water.
- h. **Use only extension cords having an electrical rating not less than the rating of the product.**
- i. **Do not use damaged extension cords.** Examine extension cord before using and replace if damaged.
- j. **Do not abuse extension cord and do not yank on any cord to disconnect.** Keep cord away from heat and sharp edges.
- k. **Always disconnect the extension cord from the receptacle before disconnecting the product from the extension cord.** If you are using an extension cord, it should always be completely unwound from the cable drum.
- l. **When replacing plugs on the power supply cable or extension lead the spray water guard and mechanical stability must remain intact.**

### **WARNING**

Inadequate extension cords can be dangerous.

### 3. PERSONAL SAFETY

- a. **Stay alert, watch what you are doing and use common sense when operating a pressure washer. Do not use washer while tired or under the influence of drugs, alcohol, or medication.** A moment of inattention while operating washer may result in serious personal injury.
- b. **Dress properly. Do not wear loose clothing or jewelry. Keep your hair, clothing and gloves away from moving parts.** Loose clothes, jewelry, or long hair can be caught in moving parts.
- c. **Avoid accidental starting. Be sure switch is "OFF" before plugging in.**
- d. **Do not overreach. Keep proper footing and balance at all times.** Proper footing and balance enables better control of the washer in unexpected situations.

### 4. WATER CONNECTION

- a. **All connecting hoses must have properly sealed joints.**
- b. **The appliance should never be used on the drinking water supply without a back flow valve.** Water which has passed the back flow valve is regarded as undrinkable.
- c. **The high-pressure hose must not be damaged** (danger of bursting). A damaged high-pressure hose must be replaced immediately. Only use hoses and connections recommended by the manufacturer.
- d. **High-pressure hoses, fittings and couplings are important for the safety of the appliance.** Use only hoses, fittings and couplings recommended by the manufacturer.

## 5. SERVICE

- a. **Tool service must be performed only by qualified repair personnel.** Service or maintenance performed by unqualified personnel could result in a risk of injury.
- b. **When servicing a tool, use only identical replacement parts. Follow instructions in the Maintenance section of this manual.** Use of unauthorized parts or failure to follow Maintenance Instruction may create a risk of electric shock or injury.

## PRESSURE WASHER SAFETY RULES

1. Before use, check that the unit and operating equipment are in perfect condition and are safe to operate. **Do not use the unit if it is not in perfect condition.**
2. **This product must be grounded.** If it should malfunction or breakdown, grounding provides a path of least resistance for electric current to reduce the risk of electric shock.
3. **Do not modify the plug provided with the product** - if it will not fit the outlet, have a proper outlet installed by a qualified electrician. Do not use any type of adapter with this product.
4. **Do not direct the jet against yourself or others in order to clean clothes or footwear.**
5. Never draw in solvent-containing liquids, undiluted acids, acetone or solvents! This includes petrol, paint thinners, heating oil. The sprayed vapour is highly flammable, explosive and toxic.
6. **The appropriate safety regulations must be observed when using the unit in dangerous areas** (e.g. petrol stations). It is forbidden to operate the unit in potentially explosive locations.
7. **The unit must be placed on a solid base.**
8. Only use detergents recommended by the manufacturer and comply with the application, disposal and warning instructions of the detergent manufacturers.
9. All current-conducting components in the working area must be protected against splashed water.
10. **The gun trigger must not be jammed in position "ON" during operation.**
11. **Wear suitable protective clothing to protect against splashing from some parts.** Do not use the appliance within the range of persons unless they also wear protective clothing.
12. **Vehicle tyres/tyre valves may only be cleaned from a minimum distance of 30 cm, otherwise the vehicle tyre/tyre valve could be damaged by the high-pressure jet.** The first indication of this is a discoloration of the tyre. Damaged vehicle tyres/tyre valves can be extremely dangerous.
13. **Materials containing asbestos and other materials which contain substances which are hazardous to your health must not be sprayed.**
14. **Detergents must not be used undiluted.** The products are safe to use as they contain no acids, alkalis or substances which are detrimental to the environment. We recommend that the detergents are kept out of the reach of children. If detergent comes into contact with the eyes, wash immediately with plenty of water and if swallowed contact a doctor immediately.

Follow the maintenance instructions specified in the manual.

## CAUTION





This machine has been designed for use with cleaning detergent supplied or recommended by the manufacturer.

The use of cleaning detergents may effect the operation of the machine and void the warranty.

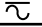

## SYMBOLS

**IMPORTANT:** Some of the following symbols may be used on your tool. Please study them and learn their meaning. Proper interpretation of these symbols will allow you to operate the tool better and safer.

Symbol	Name	Designation/Explanation
V	Volts	Voltage (potential)
A	Amperes	Current
Hz	Hertz	Frequency (cycles per second)
W	Watt	Power
min	Minutes	Time
ø	Diameter	Size of drill bits, grinding wheels, etc.
n <sub>0</sub>	No load speed	Rotational speed, at no load
.../min	Revolutions or reciprocation per minute	Revolutions, strokes, surface speed, orbits etc. per minute
	Alternating current	Type or a characteristic of current
	Direct current	Type or a characteristic of current
	Alternating or direct current	Type or a characteristic of current
	Class II construction	Designates Double Insulated Construction tools.
	Earthing terminal	Grounding terminal

## FUNCTIONAL DESCRIPTION AND SPECIFICATIONS

### NOTE:

The information contained in this Instruction Manual is designed to assist you in the safe operation and maintenance of the power tool.

Some illustrations in this Instruction Manual may show details or attachments that differ from those on your own power tool.

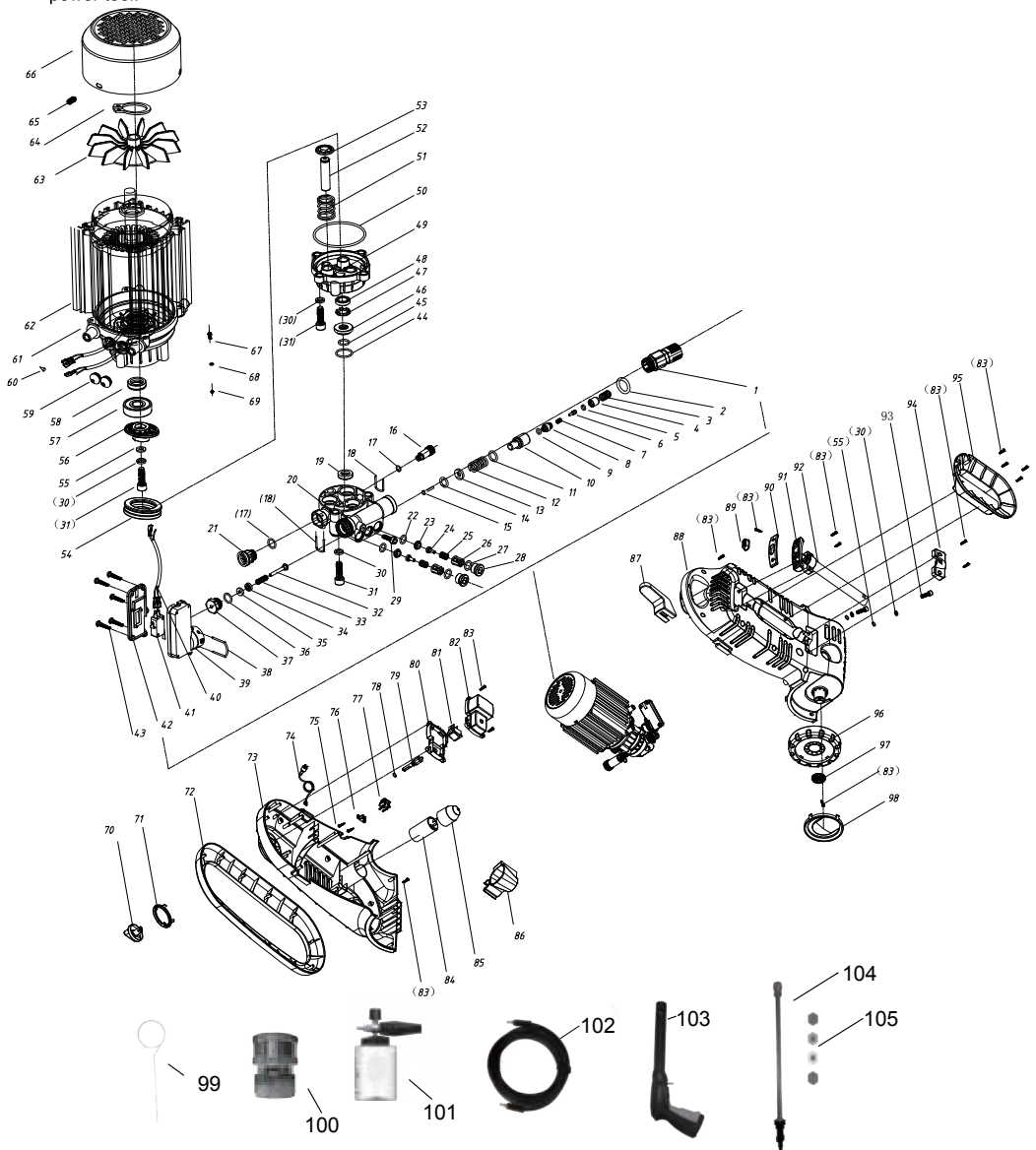

NO.	DESCRIPTION	NO.	DESCRIPTION	NO.	DESCRIPTION
1	Water Outlet Connector Assy	38	Bayonet Lock	75	Self-tapping Screw M4x15
2		39	Microswitch Assy	76	Power Cable Gripper Cover
3		40		77	Power Cable Gripper
4	Pressure Retaining Assy	41		78	O-ring 9x1.8
5		42		79	Switch Lever
6		43	Plunger Guide Ring Assy	80	Main Switch Box Cover
7		44		81	Main Switch
8		45		82	Main Switch Box
9		46		83	Self-tapping Screw M4x20
10	Piston Assy	47	Oil Seal 20x12x4	84	Capacitor
11		48		85	Capacitor Waterproof Cap
12		49	Pump Body	86	Power Gun Holder
13		50	O-ring 69x2.65	87	Hose Hook
14		51	Plunger Spring	88	Back Panel
15		52	Plunger w/Locking Ring	89	Telescopic Rod Assy
16	Water Inlet Connector	53		90	
17	O-ring 11.2x2	54	Bearing	91	
18	Bayonet Lock	55	Washer M8	92	
19	Water Seal 20x12x5	56	Cam	93	
20	Pump Head	57	Motor Assy	94	Power Cable Hook
21	Water Inlet Plug	58		95	
22	O-ring 8.2x1.9	59		96	Wheel
23	Check Valve Seat Assy	60		97	Wheel Clamp
24		61		98	Wheel Cover
25		62		99	Needle
26		63		100	Quick release hose connector
27	Check Valve Plug Assy	64		101	Foam cannon
28		65		102	High Pressure Hose
29	Inner Hexagon Screw M5x10	66		103	Power Gun
30	Spring Washer M8	67	Screw M4x8	104	Power Lance
31	Inner Hexagon Screw M8x20	68	Spring washer M4	105	Spray nozzle
32	Putter Assy	69	Lock washer		
33		70	Rotary Knob		
34		71	On-Off Indicator Plate		
35		72	Front Cover		
36		73	Front Panel		
37		74	Cable c/w Plug		

**SPECIFICATIONS**

Model	WASHR FLO
Motor	1600W
Supply Temperature Max.	50°C
Max. Operating Pressure	180Bar
Max Flow	7L/min
Protection Class	IPX5

- a. The specification apply for the rated voltage of **110V/230V**.  
For lower voltage and with models for specific countries, the specification can vary.
- b. **Intended Use**
- The product is intended for cleaning areas and objects outside the house, tools, vehicles and boats. Drainage pipes can be unclogged and rust or paint coatings can be removed if the appropriate accessories such as cleaning agents approved by **bigboi** are used. Intended Use is related to operation within 0°C and 40°C ambient temperature.

## OPERATING INSTRUCTION

### 1. Step 1

Insert the end of the hose firmly into the power gun. (Fig 1).  
Confirm the hose is locked into the power gun by pulling slightly on the hose. The hose is now securely attached to the power gun.

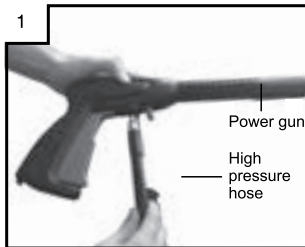

### 2. Step 2

Screw the quick release hose connector onto the water outlet connector. Insert the other end of the pressure hose into the hose connector. Failure to properly tighten the high pressure hose will result in the hose slipping or popping off immediately upon turning the unit on. (Fig 2).

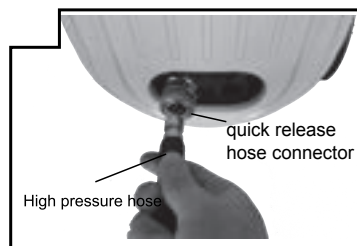
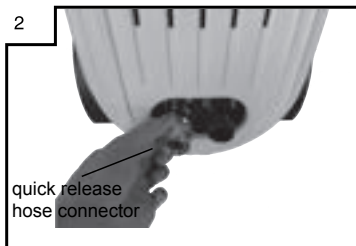

### 3. Step 3

Attached the quick hose adapter to the end of the garden hose (optional accessories) . Snap the quick hose adapter onto the quick connect filter.

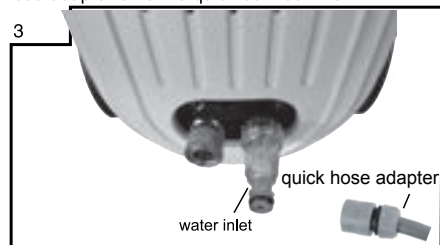

#### 4. Step 4

Connect power lance to power gun, insert lance into power gun, push together and at the same time twist clockwise to lock in place. Change the nozzle as you request(Fig 4).

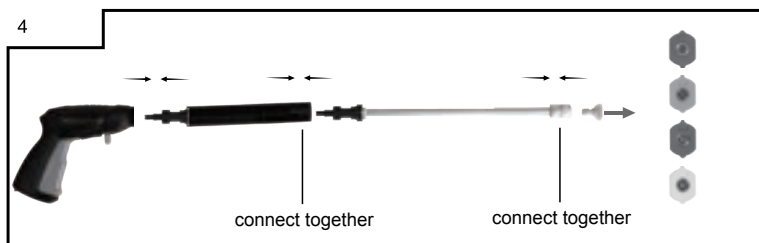

#### 5. Step 5

Rotate the power switch to the 'ON' (I) position. The motor starts only if the trigger of the gun is pulled and shuts off when the trigger is released (Fig 5).



#### 6. Adjusting the Spray

The nozzle is adjustable to allow you to change.



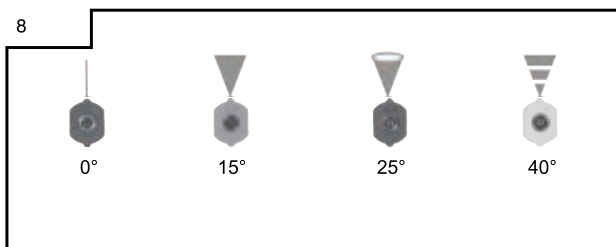

## ⚠ WARNING

TO AVOID SERIOUS INJURY, NEVER POINT SPRAY NOZZLE AT YOURSELF, PEOPLE, ANIMALS, THE UNIT OR ELECTRIC COMPONENTS

### 7. Total Stop System

The pressure washer is equipped with a total stop system to protect the motor. The motor starts only if the trigger of the gun is pulled and shuts off when the trigger is released.

### 8. Starting and Stopping

- Connect the washer to the main supply ensuring that the main switch is in the 'OFF' position.
- Ensure the washer has been correctly assembled and prepared for use.
- Press the switch to 'ON' position.
- Adjust the spray to desire position.
- Release the trigger and point the nozzle at the area to be washed.
- Press the trigger.
- Proceed the cleaning.

When you have finished your cleaning, switch off the washer and disconnect the unit:

- Press the switch to 'OFF' position.
- Turn off the water supply.
- Discharge the water in the pump and the hose by pressing the trigger for a few seconds, or until there is nothing coming out from the spray.
- Lock the trigger to 'OFF' position.
- Disconnect the main power supply.

Ensure the washer is on level ground.

**DO NOT** overreach with the high pressure hose or move the pressure washer by pulling the hose, this could cause the machine to become unstable and fall over.

**DO NOT** kick or drive a motor vehicle over the high pressure hose. **DO NOT** expose the high-pressure hose to sharp edges or corners.

**NEVER** use the roto nozzle to clean motor vehicles.

## ⚠ CAUTION

Operating with detergents. Unsuitable detergents may damage the unit and the object being cleaned.

Some painted or treated surfaces may be susceptible to damage from high pressure washer.

When cleaning vehicles, always check with the vehicles' user manual or maker whether the surfaces are suitable for pressure washing or if there any restrictions apply.

Never position the nozzle nearer than 30cm to the area being cleaned (do test on a small area before your cleaning).

Always keep the jet moving over the surface. Do not leave the jet on the same position for a prolonged period as this could cause damage to the surface.

**MAINTENANCE AND INSPECTION****⚠ WARNING** Remove plug from the power supply and disconnect from water supply.

1. Regularly check for obvious defects such as loose fixings, and worn or damaged components.
2. Check the covers and guards are undamaged and correctly fitted. Carry out necessary maintenance or repairs before using.
3. Never use the pressure washer without the strainer or a damaged strainer.
3. To move the machine, use the top handle and roll the machine on the wheels.
4. To transport the washer up or down or over obstacles, it must be lifted by the top handle.
5. If the washer is to be stored or transported horizontally, the detergent tank should be drained first.
6. Clean the exterior of the machine thoroughly using a soft brush or cloth. **DO NOT** use water, solvents or polishes. Remove all debris, especially from the ventilation slots.
7. Regularly clean the nozzle to ensure efficient running of the washer. The nozzle must be cleaned at regular intervals with using the nozzle cleaner pin as provided (Fig 9).



8. All pressure washer will eventually require servicing or replacement of parts because of wear from normal use. To assure that only authorized replacement parts will be used, all service and repairs must be performed by **bigboi** authorized service center, only.

**NOTE:** Products specifications subject to change without notice.



## TROUBLESHOOTING

**⚠ WARNING** Disconnect the machine from the power source before making any repair.

Symptom	Cause	Solution
Motor refuses to start	On/Off switch is in the "OFF" (O) position.	Turn switch to the "ON" (I) position.
	Power cord is not plugged in.	Plug in power cord.
	Extension cord is too long. Extension cord is not proper gauge. Extension cord is damaged.	Replace extension cord with either a 25ft 12/3 gauge cord or a 50ft 10/3 gauge cord.
	Electrical outlet does not supply adequate power.	Try a different outlet.
Motor stops	Fuse faulty.	Replace fuse.
	Wrong mains voltage.	Check that mains voltage corresponds to specifications on the model tag.
	Motor protector has activated.	Allow to cool for 5 minutes.
Motor starts up but no working pressure	No water supply.	Connect water supply.
	Water strainer clogged up.	Clean the water strainer.
	Nozzle clogged up.	Clean the nozzle.
Washer does not reach high pressure	Diameter of garden hose is too small.	Replace with a 1/2 inch or 5/8 inch garden hose.
	Water supply is restricted.	Check garden hose for kinks, leaks and blockage.
	Not enough inlet water supply.	Open water source full force.
	Water inlet filter is clogged.	Remove filter and rinse out with warm water.
	Spray wand is on low pressure position.	Turn spray wand to high pressure position.
Output pressure varies high and low	Not enough inlet water supply.	Turn water on full force. Check garden hose for kinks, leaks or blockage.
	Pump is sucking air.	Check that hoses and fittings are air tight. Turn off machine and purge pump by squeezing trigger gun until a steady flow of water emerges through the nozzle.
	Water inlet filter is clogged.	Remove filter and rinse out with warm water.
	Discharge nozzle is obstructed.	Blow out or remove debris with a fine needle.
	Calcified gun, hose or spray wand.	Run distilled vinegar through detergent tank.

Symptom	Cause	Solution
No detergent	Detergent is too thick.	Dilute detergent.
	Spray wand is in high pressure position.	Turn spray wand tip to low pressure position.
	Discharge nozzle is obstructed.	Blow out or remove debris with a fine needle.
Spray wand leaks	Spray wand not properly attached.	Insert the spray wand into the trigger gun. Carefully press in against the spring tension and twist into the locked position.
	Broken o-ring or plastic insert.	Please contact bigboi customer service.
Pump is noisy	Pump is sucking air.	Check that hoses and fittings are air tight. Turn off machine and purge pump by squeezing trigger gun until a steady flow of water emerges through the nozzle.
Water leaks from pump	Loose fittings.	Check that all fittings are tight.
	Water seals are damaged or worn.	Please contact bigboi customer service.
Oil drip	Oil seals are damaged or worn.	Please contact bigboi customer service.





For more information on any bigboi product's  
Please visit [www.ibigboi.com](http://www.ibigboi.com) or email us on  
[sales@ibigboi.com](mailto:sales@ibigboi.com)